

# PLAT OF SURVEY LOT 10 OF BLOCK 3 LAKEWOOD TRAILS SUBDIVISION

LOCATED IN THE NE 1/4 AND THE NW 1/4  
OF THE NW 1/4 OF SECTION 1, TOWN 1 NORTH,  
RANGE 16 EAST, VILLAGE OF WILLIAMS BAY,  
WALWORTH COUNTY, WISCONSIN

PLAT OF SURVEY  
LOT 10 BLOCK 3  
LAKEWOOD TRAILS SUBDIVISION

WORK ORDERED BY: FAIRWYN LTD.  
BRIAN C. POLLARD, PRESIDENT  
772 W. MAIN STREET, SUITE 106  
LAKE GENEVA, WISCONSIN 53147  
(414) 248-5010 FAX: 248-2721

FARRIS, HANSEN & ASSOCIATES, INC.  
Engineering, Architecture, Surveying  
7 Ridgway Court P.O. Box 437  
ELKHORN, WISCONSIN 53121  
Office: (414) 723-2098  
Fax: (414) 723-5886

REVISIONS

PROJECT NO.  
3836.03-10  
DATE:  
07/17/96  
SHEET NO.  
1 OF 1

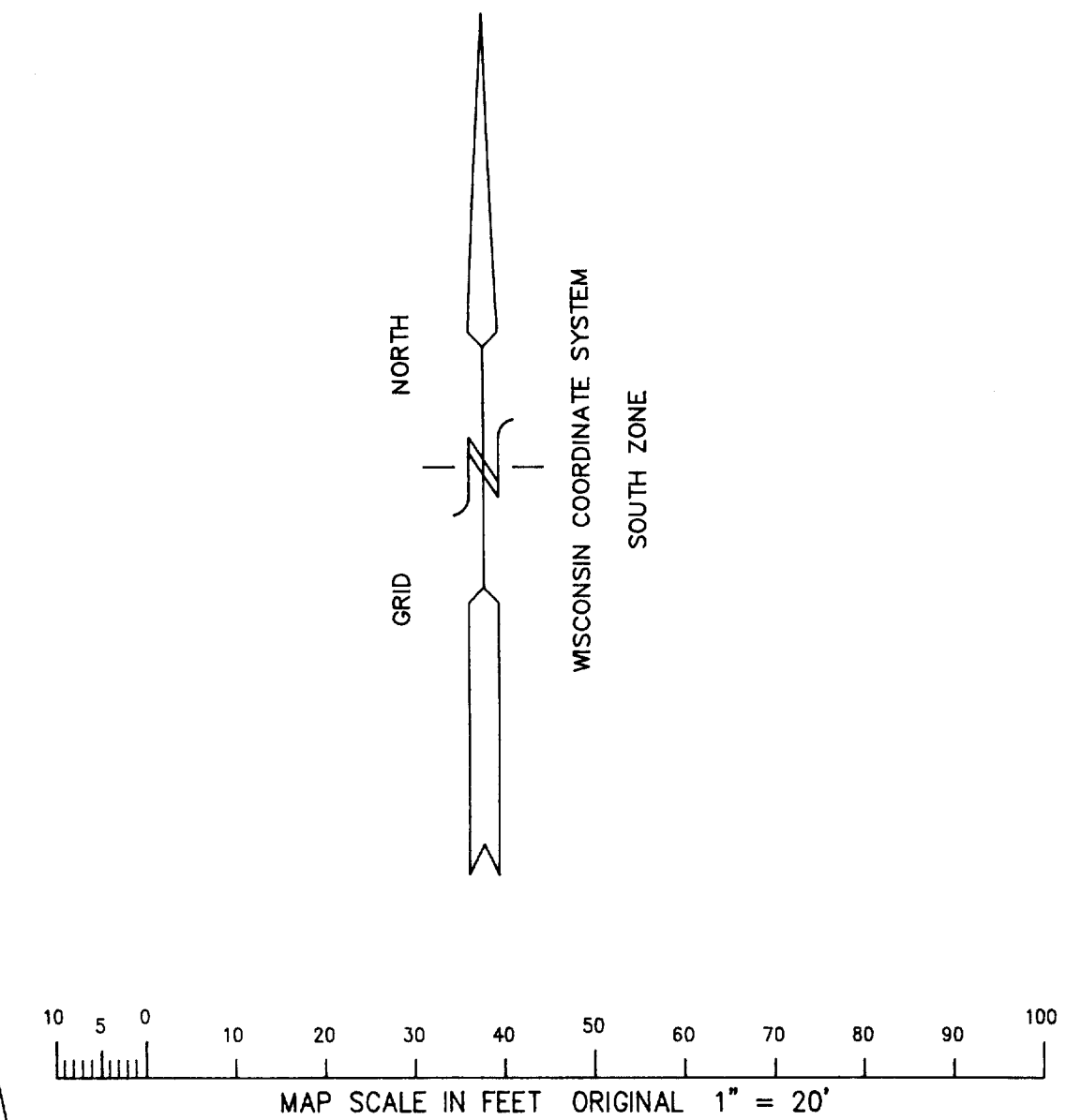

- = FOUND IRON PIPE STAKE 1" DIA.
- = FOUND IRON REBAR STAKE 3/4"
- = FOUND CONCRETE COUNTY MONUMENT
- ⦿ = FOUND SOLID ROUND IRON BAR STAKE 1 5/16"

( XXX ) = RECORDED AS

NOTE: GENERAL EASEMENT IS A COMBINATION  
OF UTILITY, DRAINAGE, AND WALKWAY EASEMENTS.

NOTE: COPIES OF THIS MAP TO WHICH THE FOLLOWING CERTIFICATE  
WILL APPLY ARE BLUE LINE PRINTS SHOWING SURVEYOR'S ORIGINAL  
SEAL AND SIGNATURE IN BLACK INK. COPIES BY ANY OTHER MEANS  
MAY HAVE ALTERATIONS WHICH DO NOT REPRESENT THE SURVEYOR'S  
WORK PRODUCT.

I HEREBY CERTIFY THAT THE ABOVE DESCRIBED PROPERTY HAS BEEN  
SURVEYED UNDER MY DIRECTION AND THAT THE ABOVE MAP IS A TRUE  
REPRESENTATION THEREOF AND SHOWS THE SIZE AND LOCATION OF  
THE PROPERTY AND ITS EXTERIOR BOUNDARIES. THIS SURVEY IS  
MADE FOR THE USE OF THE PRESENT OWNERS OF THE PROPERTY, AND  
ALSO THOSE WHO PURCHASE, MORTGAGE, OR GUARANTEE THE TITLE  
THERETO WITHIN ONE YEAR FROM THE DATE HEREON.

DATED: 7-17-1996

PETER S. GORDON R.L.S. 2101

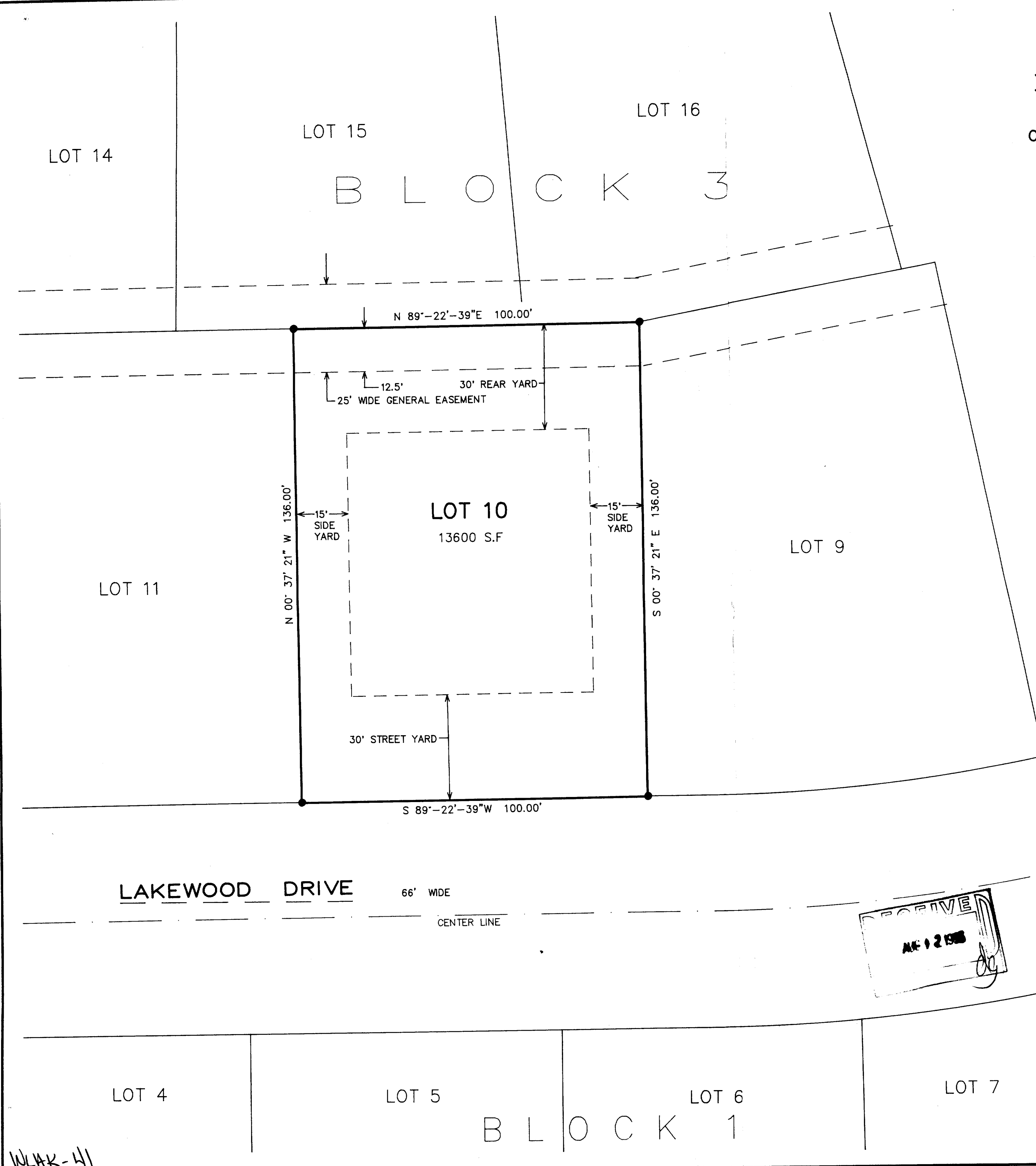
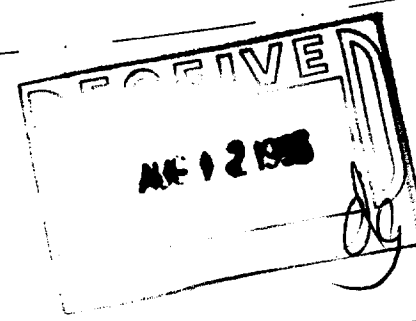
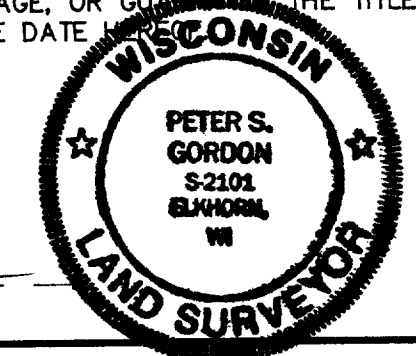

WLAK-41  
11-1149